



*High Performance ATV Trailers*



**1600 UTILITY**  
**OWNERS MANUAL**  
**&**  
**ASSEMBLY INSTRUCTIONS**

**CAUTION:**

Read Rules for Safe  
Operation and Assembly  
Instructions Carefully



**NEED HELP? Please visit us at [www.ATVWAGON.com](http://www.ATVWAGON.com)**

# Safety Rules

Remember, any piece of equipment like an ATV trailer can cause injury if operated improperly or if the user does not understand how to operate the equipment. Exercise caution at all times when using your tow vehicle and tow trailer.



**LOOK FOR THIS SYMBOL TO POINT OUT IMPORTANT SAFETY PRECAUTIONS. IT MEANS -- ATTENTION! BECOME ALERT! YOUR SAFETY IS INVOLVED.**

## **Please exercise caution at ALL times when using the trailer on your tow vehicle:**

- Read this owners manual before attempting to assemble or operate trailer.
- Read the tow vehicle's owners manual and know how to operate your tow vehicle before using the trailer.
- Do not transport people on or inside the trailer. The transport of people puts their lives at risk and may be illegal as the trailer has not been designed to carry passengers.
- Do not allow adults to operate tow vehicles or trailers without proper instructions and experience.
- Never allow children to operate the tow vehicle or the trailer.
- Recommended tow vehicle engine size is 350 cc or larger with four-wheel drive in order to allow safe operation when towing the trailer.
- Use caution when towing the trailer over rough terrain and hillsides to prevent rolling over and loss of control. Be careful towing the trailer in icy, wet, or snowy conditions which could impair the braking ability of the trailer and the tow vehicle.
- Tow Vehicle braking and stability may be affected when towing this trailer.
- Using the trailer with a heavy load may inhibit the towing capacity of the tow vehicle. Do not exceed the maximum towing capacity of your vehicle. Check the vehicle's owners manual on tow capacity limitations.
- Before operating vehicle on any sloped surface or hill, refer to the safety rules in the vehicles owners manual on proper operation on slopes. Use extreme caution on steep slopes.
- Do not tow trailer on highways or on public thoroughfares. The trailer is designed for off road use only.



**CAUTION: VEHICLE BRAKING AND STABILITY MAY BE AFFECTED WITH THE ADDITION OF THIS TRAILER. BE AWARE OF CHANGING CONDITIONS ON SLOPES AT ALL TIMES.**



**CAUTION: AN IMPROPERLY COUPLED TRAILER CAN RESULT IN DEATH OR SERIOUS INJURY. TIGHTEN THE COUPLER ADJUSTMENT REGULARLY.**

## **WARNING**

Driving too fast for conditions can result in loss of control and cause death or serious injury.

- Decrease your speed as road, weather and lighting conditions deteriorate.

## **WARNING**

Improper tire pressure can result in a blowout and loss of control, which can lead to death or serious injury.

- Be sure tires are inflated to pressure indicated on sidewall before towing trailer.

## **WARNING**

An improperly coupled trailer can result in death or serious injury.

Do not tow the trailer until:

- The coupler is secured and locked to hitch;
- **The coupler is adjusted properly to fit the towing vehicle ball**
- Tires and wheels are checked;
- The trailer brakes (if applicable) are checked;
- The load is secured to the trailer; and
- The trailer lights are connected and checked

## **WARNING**

Lug nuts are prone to loosen after initial installation, and if improperly tightened can lead to death or serious injury.

- Check lug nuts for tightness on a new trailer or when wheel(s) have been remounted after the first 10, 25 and 50 miles of use. Tighten lug nuts before each use.

## **WARNING**

An overloaded trailer or improper distribution of load weight or shifting cargo can result in loss of control of the trailer, leading to death or serious injury.

- Do not exceed the trailer Gross Vehicle Weight Rating (GVWR).
- Tie down all loads with proper sized fasteners, ropes, straps, etc.

Be sure to:

- Distribute the load front-to-rear and provide proper tongue weight;
- Distribute the load evenly, right and left, to avoid tire overload; and
- Keep the center of gravity low.

## **WARNING**

Improper electrical connection between the tow vehicle and the trailer will result in inoperable lights and electric brakes, and can lead to collision.

Before each use:

- Check tail/brake light functions properly
- Check electric brakes (if applicable) function properly by operating the brake controller on the tow vehicle.

### LIMITED WARRANTY TO CONSUMERS

Bosski warrants the goods to be new and free from material defect for one (1) year from the date of Bosski's delivery of the goods to Buyer. This warranty will be satisfied by Bosski's repairing the goods or furnishing replacement goods or parts, at its option. To take advantage of this warranty, Buyer must immediately notify Bosski of the claimed defect. Bosski shall have no obligation under this warranty for (a) goods which have been repaired or altered by any party other than Bosski, and or (b) defects which result from misuse, accident, or improper connection of the goods to a tow vehicle, and or (c) commercial use of the product. THIS IS BUYER'S EXCLUSIVE REMEDY UNDER WARRANTY. BOSKI DISCLAIMS ALL OTHER WARRANTIES, EXPRESS OR IMPLIED, INCLUDING BUT NOT LIMITED TO WARRANTIES OF MERCHANTABILITY, FITNESS FOR A PARTICULAR PURPOSE, AND AGAINST INFRINGEMENT. THIS WARRANTY IS NOT TRANSFERABLE.

# ATV WAGON

BY BOGGI

## High Performance ATV Trailers

**Congratulations!** You have purchased the best, and most versatile pull-behind ATV trailer on the market today.

Please follow the enclosed instructions closely, and your assembly should be effortless and quick. For your convenience we have pre-assembled and packaged as many components as possible.

All torque settings listed in this manual are based on a dry, non lubricated bolt. Over-torquing may result in bolt failure, and under-torquing may result in nuts working loose.



**CAUTION:** After first 5 hours of use check all fasteners for appropriate tightness. Tighten wheel lug nuts before each use.

Be sure to repack your wheel bearings as needed with a high quality grease. Repack more often under high use or in wet conditions. Check the website [www.atvwagon.com](http://www.atvwagon.com) for the latest updates, tips, and advice.

### RECOMMENDED TOOL CHECK LIST



9mm, 13mm,  
18mm & 19mm  
Wrenches



Torque Wrench and/or Ratchet

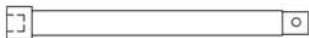

4 inch extension



18mm, 19mm, & 13/16"  
Sockets. A 13/16 " lug wrench  
could replace the socket



**BEFORE OPERATING YOUR ATV WAGON, read, understand, and follow the safety rules on page 2 and the warnings listed on page 3 as well as the cautions listed throughout the manual.**

# ATV WAGON PARTS LIST

Numbers in ( ) indicate quantity

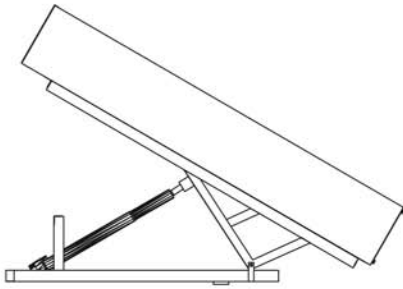

**(1) - Trailer Bed Assembly**



**(1) -Idler Axle Assembly**

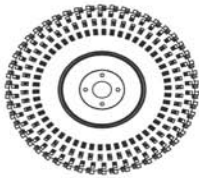

**(4) -Tire and Wheel Assembly**



**(1) -Brake Axle Assembly**



**(1) -Trailer Tongue Assembly**



**(1) -Electric Lift Controller**



**(1) -ATV Wiring Harness & Connectors**

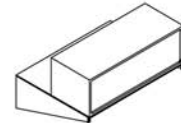

**(1) -Tail Light Assembly**

## **HARDWARE CHECK LIST**

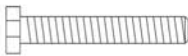

**(12) 12mm x 76mm Bolt**



**(24) 12mm Washer**



**(12) 12mm Nuts**



**(16) 12mm Tapered Nuts**



**(10) 6mm x 70mm Bolts**



**(10) 6mm x 70mm**



**(12) 6mm Nuts**

# TRAILER ASSEMBLY

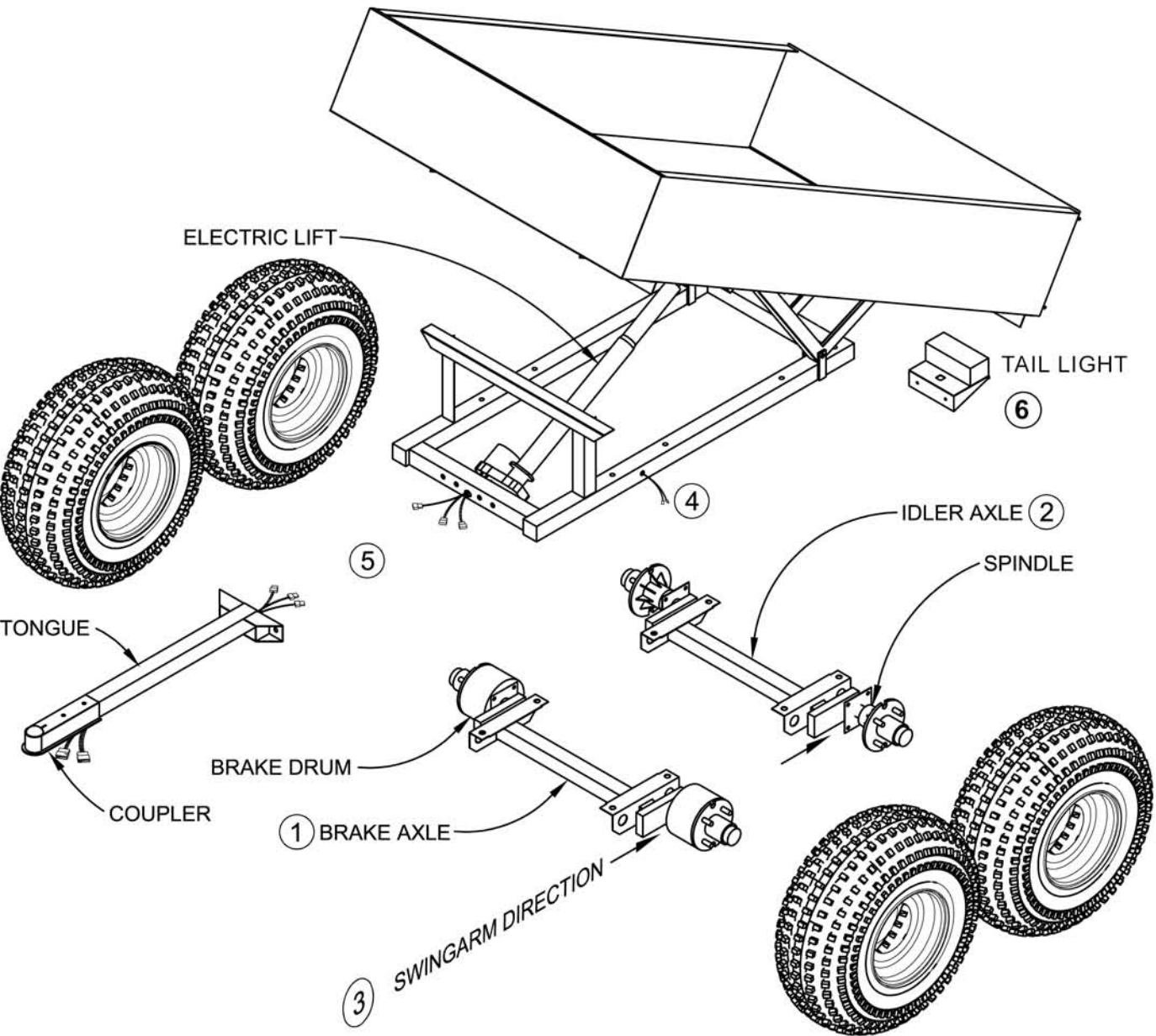

**BEFORE OPERATING YOUR ATV WAGON, read, understand, and follow the safety rules on page 2 and the warnings listed on page 3 as well as the cautions listed throughout the manual.**

## ATV WAGON ASSEMBLY INSTRUCTIONS:

Install each axle to the frame with (4) 12mm x 76mm bolts, each with (2) washers and (1) nut. Tighten to 50 to 71 ft-lbs (68 to 96 nm).

The brake axle (1) installs in the front position of the frame with the idler axle (2) to the rear.

It is important that the axles are installed with the swingarms trailing the main axle beam, as shown in the assembly diagram (3)

Connect the wires (4) from the trailer frame to the brakes.

---

Mount each wheel/tire assembly to the axle hubs with the 4 tapered nuts.

To insure that the wheels and tires are mounted correctly, they should be installed with the valve stems facing away from the frame.

Tighten the nuts gradually, alternating between nuts opposite each other to assure even seating of the wheel onto the axle. Tighten nuts to 50 to 71 ft-lbs (68 to 96 nm).

---

On the tongue assembly, connect the male electrical connectors to the female electrical connectors, ensuring that the colors of the wires match on both connectors. (5)

After connecting the first set of male/female connectors, push them into the tongue of the trailer before making the next connection.

Repeat with the remaining two sets of connectors, ensuring that no connectors or wires are exposed, so the wires do not become pinched between the frame and the tongue.

Install the tongue assembly to the frame with (4) 12mm x 76mm bolts, each with (2) washers and (1) nut. Tighten to 50 to 71 ft-lbs (68 to 96 nm).

Mount the tail light assembly (6) to the frame using (2) 6mm x 70mm, each with (2) washers and (1) nut.

USE A 2" BALL ONLY



**CAUTION: AN IMPROPERLY COUPLED TRAILER CAN RESULT IN DEATH OR SERIOUS INJURY. TIGHTEN THE COUPLER ADJUSTMENT REGULARLY.**



## **ATV WIRING INSTALLATION**

The ATV wiring harness has a 4-pole connector at one end and no connector at the other end. This harness connects the trailer to the ATV's taillight and battery.

Splice these wires, using the supplied connectors, into the appropriate ATV wires, as shown below. Be sure to install a 30 amp fuse on the black wire.

From there, route the connector-end of the wire to the rear of the ATV.

Be sure to leave enough extra wire to accommodate the turning requirements when pulling your ATV Wagon.

Seal all splices to insure that water does not corrode or short the electrical wiring.

Refer to the owner's manual or wiring schematic for the specifics of your ATV.

When you are ready to use the ATV Wagon, plug the connector end into the 4-pole connector at the trailer coupler.

### **WIRING HARNESS-TO-ATV**

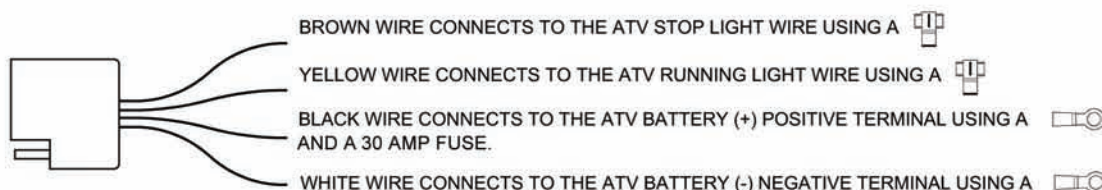

## **ELECTRIC LIFT CONTROLLER**

Mount the Electric Lift Controller on the left side of the ATV handlebar.

Position the brackets on the handlebar then bolt the switch on to the handle bar brackets.

Make sure the switch is positioned so that the wires are below the handlebar, and the controls are accessible with the operators thumb.

Route the wire from the controller switch to the rear of the ATV.

Conceal and secure any excess wire to the ATV.

When you are ready to use the ATV Wagon, plug the 3-pole male connector into the 3-pole female connector at the trailer coupler.



**BEFORE OPERATING YOUR ATV WAGON, read, understand, and follow the safety rules on page 2 and the warnings listed on page 3 as well as the cautions listed throughout the manual.**



# WIRING SCHEMATIC FOR 1600 UTILITY

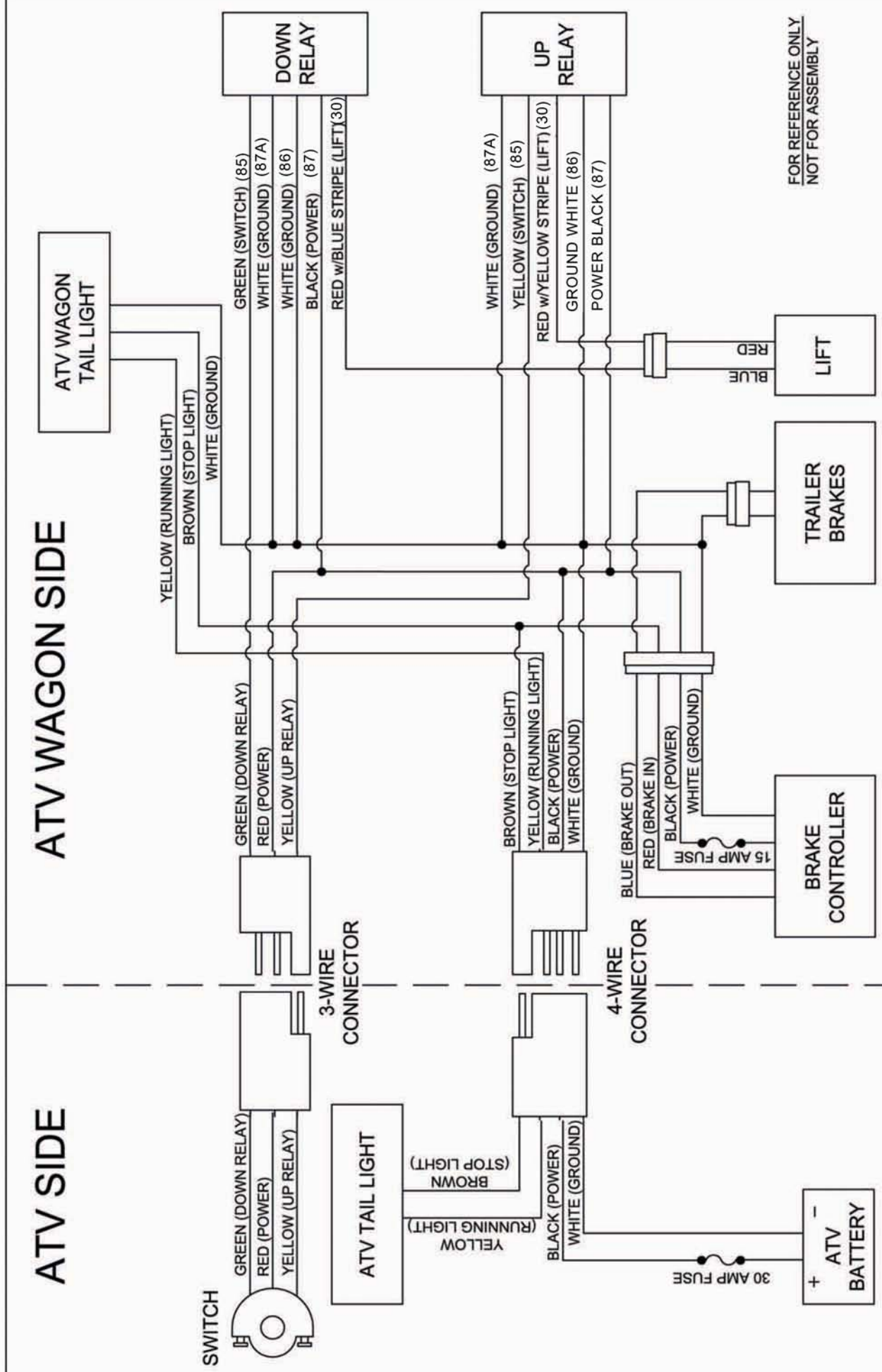

FOR REFERENCE ONLY  
NOT FOR ASSEMBLY

The logo features the words "ATV WAGON" in a stylized font. "ATV" is in a bold, italicized, sans-serif font with a 3D effect, while "WAGON" is in a clean, bold, sans-serif font. The text is set against a black and white checkered background that curves around the letters.

**ATV WAGON**

*BY BOSSKI*

*High Performance ATV Trailers*

**NEED HELP?**

**Please visit us at [www.ATVWAGON.com](http://www.ATVWAGON.com)**

